

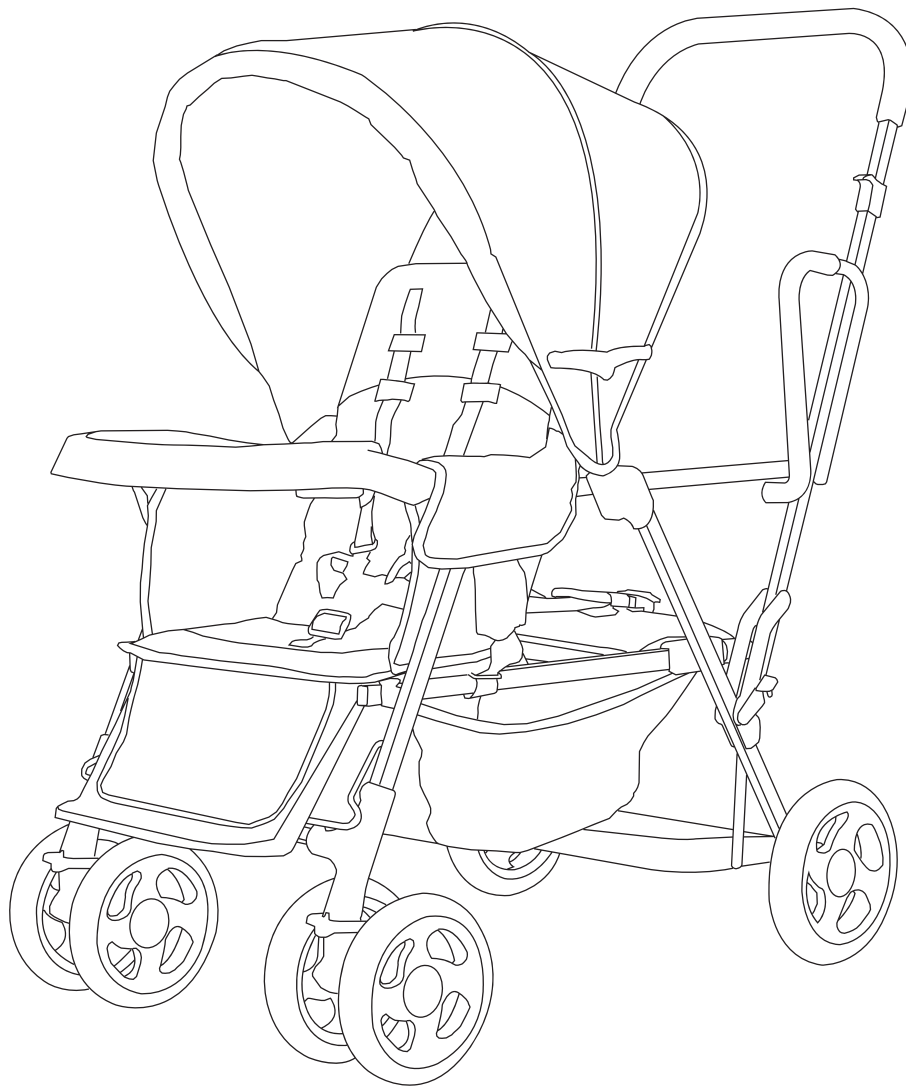

# **Caboose Stand-On Tandem Instruction Manual**

**40X & 41X Series**

**Patent No. 5,622,375**



Joovy • 2919 Canton Street • Dallas, TX 75226 • (877) 456-5049 • Fax: (214) 761-1774  
Email: [customerservice@joovy.com](mailto:customerservice@joovy.com) • Web Site: [www.joovy.com](http://www.joovy.com)



# WARNINGS

**Please read this instruction manual completely before using this stroller. Keep these instructions for future reference.**

- Failure to follow these instructions could result in serious injury or death.
- Never leave child unattended.
- Avoid serious injury from falling or sliding out.
- Always use safety belts and ensure that all children are positioned according to these instructions.
- Keep all small parts out of reach of children while assembling the stroller.
- Be certain that the stroller is fully opened, the safety latch is in position, and the wheel brakes are on before allowing children near the stroller.
- The maximum weight of the child that can be seated in the front seat is 45 lbs.
- The rear stand-on platform and the rear bench seat are designed for a child that is at least 2-1/2 years old but LESS than 44 inches tall and less than 45 lbs.
- Use of the stroller with two children weighing more than 45 pounds each, or children totaling more than 90 pounds, will cause excessive wear and stress on the stroller and may cause a hazardous unstable condition.
- Never use this stroller to carry more than 2 children at the same time.
- Never allow a child to step on the footrest to get into or out of the stroller.
- Do not use the stroller on stairways or escalators.
- The included parent organizer is for use ONLY on the Joovy Caboose stroller. DO NOT use it on other stroller models.
- Never carry hot beverages or open containers in the parent organizer. Maximum weight allowed is 5 pounds.
- Hanging purses, shopping bags, parcels, diaper bags or other accessory items from the handle bars or any other parts of the stroller may change the balance of the stroller and cause a hazardous unstable condition.
- The maximum weight that can be carried in the storage basket is 5 pounds. Excessive weight may result in a hazardous unstable condition.
- The total weight of contents in the seatback mesh pockets should be less than 2 pounds. Excess weight may cause a hazardous unstable condition.
- When installing an infant carrier onto the stroller, ALWAYS use the restraining strap to secure the carrier in place.
- Never allow your stroller to be used as a toy.
- Discard all packaging materials properly. Do not allow children to play with them.
- Check your stroller for loose rivets, snaps, worn parts, and torn material or stitching on a regular basis.
- Discontinue use of the stroller should it malfunction or become damaged.

**Please do not return this product to the store**

If you experience any difficulty with the assembly or use of this product, or if you have a question regarding these instructions, please contact our Customer Service Department at (877) 456-5049 between the hours of 8:30 am and 5:00 pm Central Time.

**Please note: Styles and colors may vary.**

# Assembling and Using your Stroller



**To ensure safe operation of your stroller, please follow these instructions carefully.**

## Unpacking the Product

- Carefully remove stroller and all parts from the box and plastic bag.
- Identify the parts (stroller, front wheels (2), rear wheels (2), canopy, tray, car seat carrier support, rear axle, small washer (4), snap pin (2), hub cap (2), and documents) with the pictures in Figures 1.

NOTE: The rear axle is attached with red tie wraps to the rear frame tube. Please carefully detach the axle from the frame and remove the yellow foam from the ends of the axle for installation. Also, extra washers and snap pins may be included.

- Discard all packaging materials properly.
- Remove the plastic coverings from all foam handles and any other areas of the product and discard also.
- DO NOT allow children to play with any packaging materials.

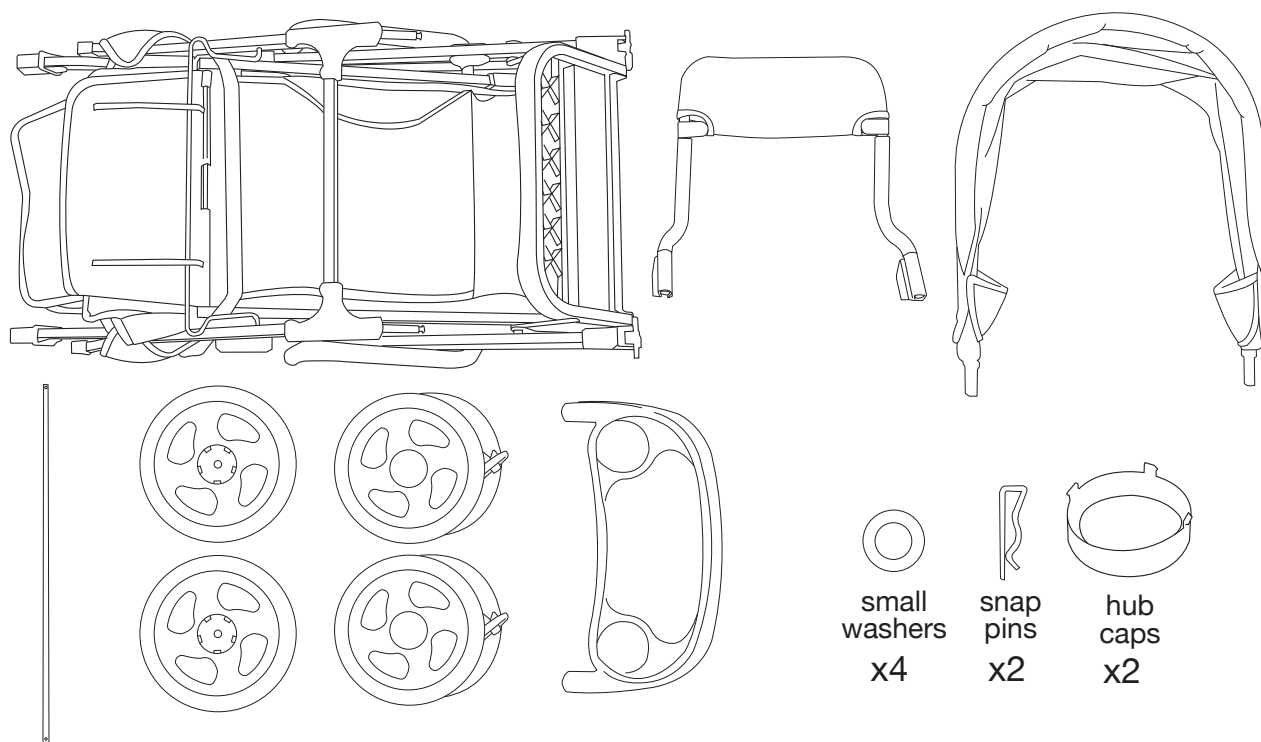

**Figure 1**



## **CAUTION**

**Adult assembly is required for this product. This package contains small parts. Keep all small parts away from children during assembly.**  
**No Tools Required.**

## Unfolding the Stroller

- Keep children away from stroller while unfolding.
- Position the stroller with the handle bar closest to you.
- Release the locking latch located on the right side by lifting the lever off of the extended rivet. See Figure 2.
- Lift up slightly on the handle of the stroller. Then place one foot onto the rear platform and pull up and back on the handle until both side frame bars snap into their locking positions in the frame.

CAUTION: While unfolding the stroller, be careful to keep your fingers from being pinched by moving parts.

NOTE: Remove packing foam from rear frame assembly to ensure stroller locks in the open position.

- Lock the safety latch on the lower left side of the stroller by pushing the lever down over the extended rivet. See Figure 3.
- Ensure that the stroller is completely opened and the safety latch is secured before ANY use of the stroller.

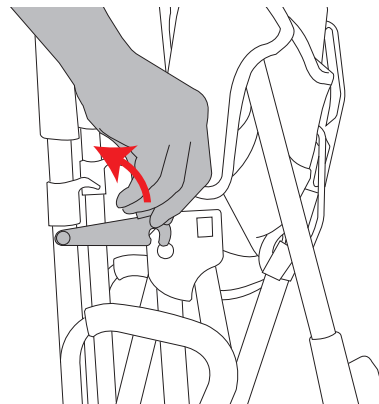

Figure 2

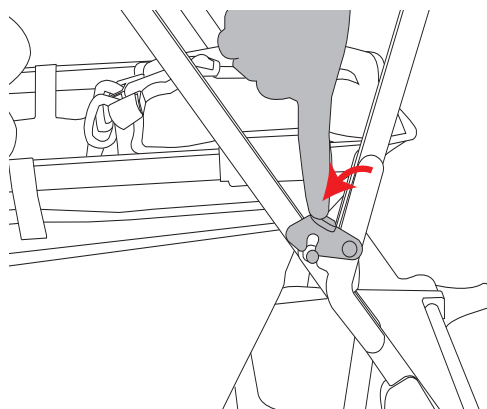

Figure 3

## **WARNING**

**ALWAYS** secure the safety latch on the side of the stroller when it is in the unfolded use position. This will prevent collapse of the stroller should the handle trigger locks be accidentally opened.

## Installing the Rear Wheels

Please use the following component sequence that indicates how all the parts for the rear wheel assembly are installed.

- Turn stroller upside down so that it rests on the handlebar.
- Insert one end of the rear wheel axle through a rear axle hole in the plastic bracket under the stand-on platform.
- Push the axle across and into the axle hole on the other side of the stroller.

NOTE: You may need to guide the axle into this hole. Slide washers over each end of the axle.

- Place one rear wheel over one end of the axle. See Figure 5.

NOTE: The brake teeth on the wheel should be facing inward toward the red brake lever AND the arrow shapes on the tire tread should point toward the handlebar.

- Slide an additional washer over the end of the axle.
- Take one snap pin and insert the straight leg into the small hole in the axle. Push it firmly into this hole until the round portion of the other leg snaps completely around the outside of the axle.
- Push the axle as far as it will go toward the opposite side of the stroller, then repeat the installation steps for the other wheel.
- Install a hubcap onto each wheel by aligning the 5 tabs on the hubcap with the 5 slots in the wheel, and then pushing it into place. Ensure that ALL 5 snaps have engaged securely and the hubcap cannot be pulled off.

## Installing the Front Wheels

- Take one of the double wheel sets and locate the small hole in the rotating bracket that is inside the red lever.
- Push the front axle into this hole and keep pushing the wheel set onto this axle until you hear an audible click. See Figure 4.
- Pull downward on the wheel set to ensure that it has locked into position on the axle. Also ensure that both wheels rotate and roll smoothly.
- Repeat this same procedure for the other wheel set.

### REAR WHEEL SEQUENCE

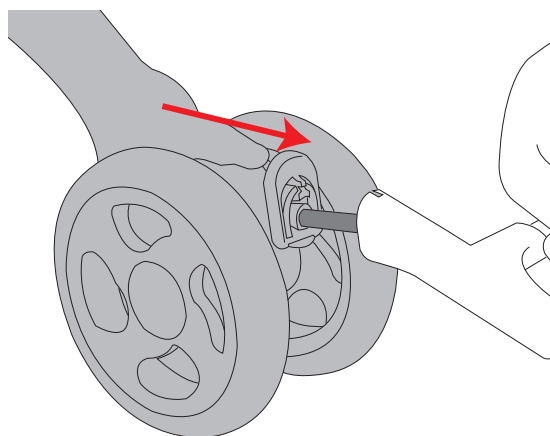
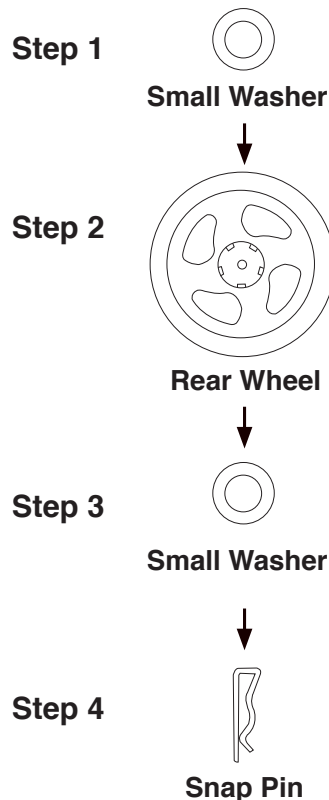
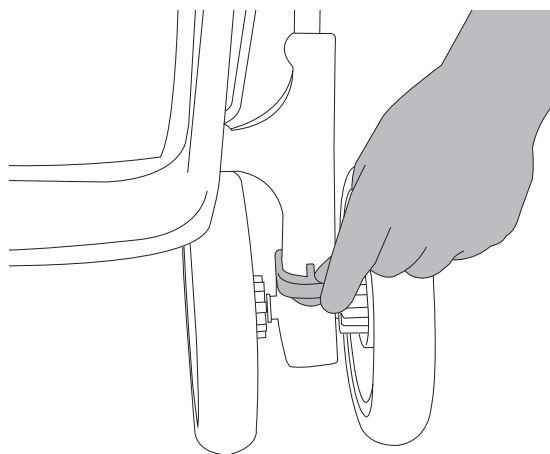

Figure 4

## Front Wheel Locks

The front wheels can be either in swivel mode or locked mode.

- To put the front wheels in their locked mode, first rotate each wheel set so that the wheels are pointed straight ahead.
- Pull up on the lever to engage the small tab on the lever with the slot in the plastic frame sleeve. The lever can be either facing forward or rearward to lock the wheels. See Figure 5.
- To unlock the wheels and put them into swivel mode, push down on the lever to disengage the tab from the slot.



**Figure 5**

## Installing and Operating the Canopy

- To attach the canopy, position the canopy with the thick padded edge towards the front of the stroller.
- Line up the male fittings on the canopy with the female fittings near the center of the stroller and push downward until the fittings snap into place. See Figure 6. Pull upward on the canopy sides to be sure both are snapped securely in place.
- To open the canopy, pull forward on the front edge of the canopy while holding the back edge in place. Once the canopy is fully opened, push down on BOTH side hinges to lock it in the open position.
- The canopy will ratchet forward or backward to block the sun. Pull forward on the front of the canopy frame tube to rotate it forward. Pull backward on the rear frame tube to rotate it backward. See Figure 7.
- To close the canopy, unlock the side hinges and pull the front edge toward the rear of the stroller until folded. See Figure 8.
- To remove the canopy, press the lock button on the side of each of the male fittings while pulling upward on the canopy frame. See Figure 9.

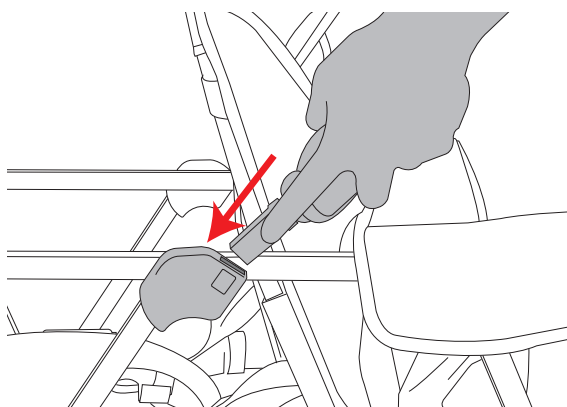

**Figure 6**

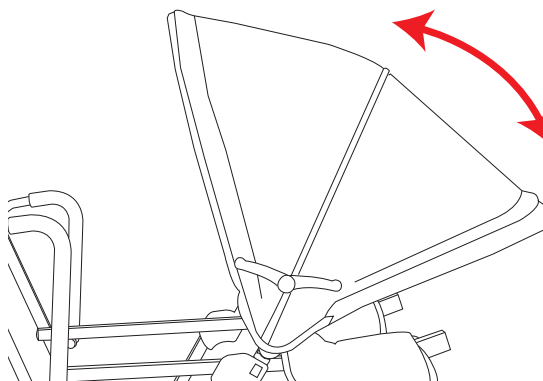

**Figure 7**

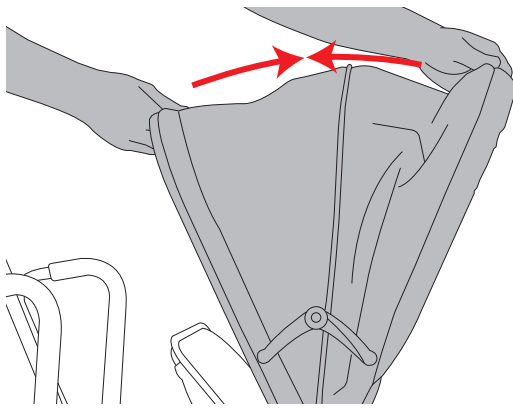

**Figure 8**

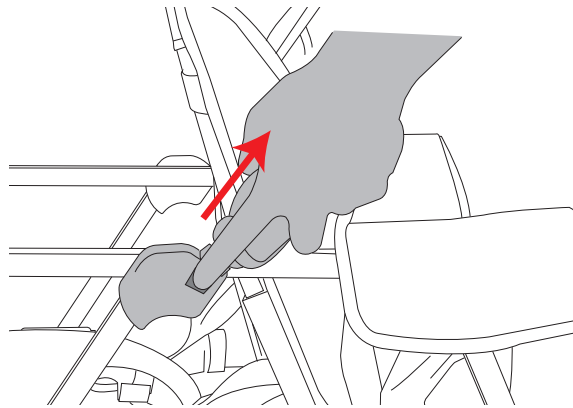

**Figure 9**

## **WARNING**

**Possible pinching hazard - Be careful when closing and opening the side hinges so as not to pinch your fingers.**

### **Attaching/Detaching the Front Tray**

- To attach the front tray, line up the female fittings on the tray with the male fittings on the front of the stroller and push inward until the fittings snap into place. See Figure 10. Pull outward on both sides of the tray to be sure both are snapped securely in place.
- To remove the front tray, press the lock button on the side of each of the male fittings while pulling outward on the tray. See Figure 11.

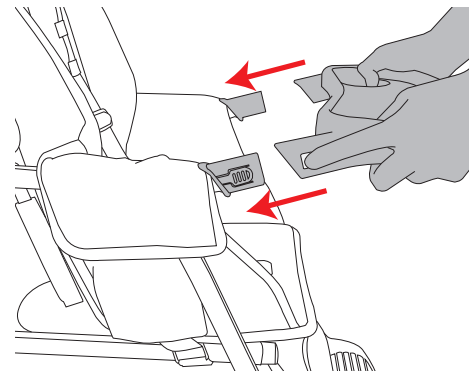

**Figure 10**

## **WARNING**

**The child tray is not a restraint device. Always secure your child with the seat belt. Never lift the stroller by the child tray. Use caution when attaching the child tray when there is a child seated in the stroller.**

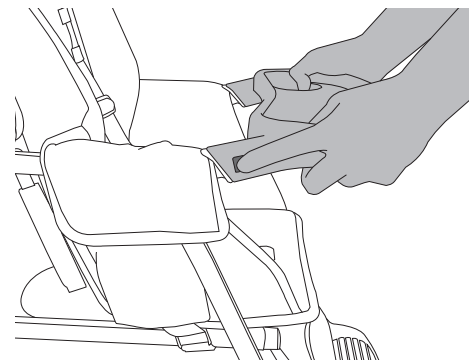

**Figure 11**



## Rear Wheel Brakes/Parking Device

- Before placing any child into the stroller or removing them from the stroller, be certain that the rear wheel brakes are engaged.
- To engage the rear wheel brakes, push down on the brake levers located on each rear wheel. See Figure 12. The stroller may require slight forward or rearward movement in order to line up the teeth on the brake with each wheel brake cluster.
- Check that the brakes are properly applied by attempting to push the stroller backward and forward.
- To release the brakes, gently lift up on the brake levers. See Figure 13.

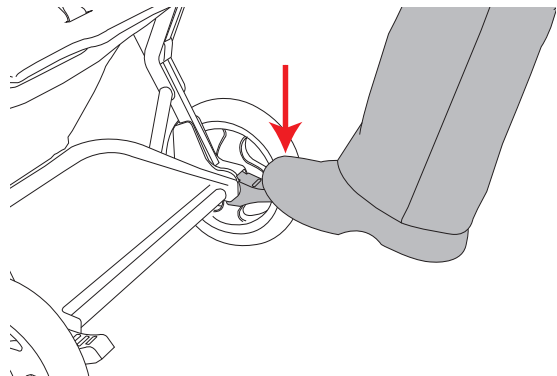

Figure 12

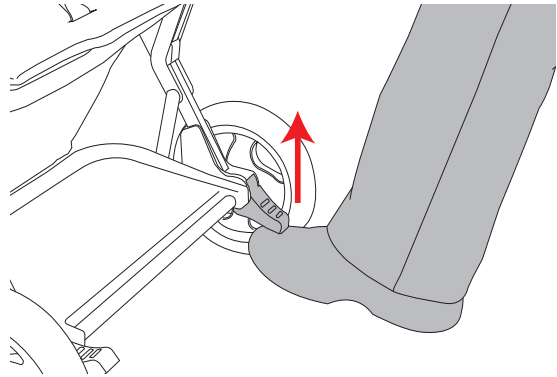

Figure 13

## **WARNING**

**Always engage BOTH parking brakes when the stroller is not being pushed so that it will not roll away. Never leave stroller unattended, especially on a hill or incline, as the stroller may tip over or slide.**

## Adjusting the Footrest

The footrest can be adjusted to two positions – horizontal or all the way down.

- To place the footrest into the horizontal position, pull up on the footrest and position the footrest lower bar into the UPPER slot at the middle of the plastic bracket on the underside of the footrest. See Figure 14.
- Ensure that the bar is located securely into this slot on BOTH sides of the footrest. Push down on both sides of the footrest to ensure it is secure.
- To place the footrest into the down position, pull up on the footrest to release the bar from the slot. Lower the footrest slightly while moving the bar into the LOWER slot of the plastic bracket on BOTH sides of the footrest. See Figure 15.
- Lower the footrest to its down position. Note that the footrest will not “lock” into the down position, but will remain there by gravity only.

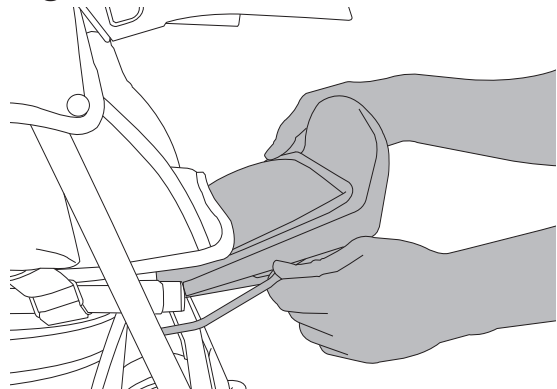

Figure 14

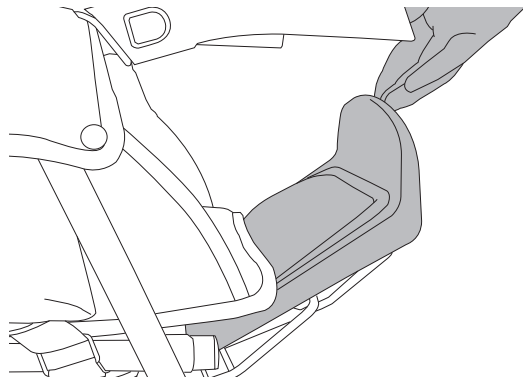

Figure 15

## **WARNING**

**Never allow a child to step onto the footrest in either position in order to get into or out of the stroller. This may cause the stroller to tip over and injure the child.**



## Securing the Front Seated Child

- Ensure that both shoulder straps are attached to the waist strap buckles. See Figure 16.
- Unlatch the waist/shoulder buckle by squeezing the latch releases on both sides of the buckle and removing the male ends of each buckle.
- Carefully place the child in the seat with the shoulder straps over their shoulders and chest. Then place the crotch strap between the child's legs.

NOTE: There are three height adjustment positions for the shoulder harness straps. For a younger child, the shoulder straps should be positioned through the lower sewn-in loops on the seatback. For a young child that is tall, the shoulder straps may be positioned through the upper sewn-in loops on the seatback. For a taller child, use the shoulder straps **WITHOUT** positioning them through these sewn-in loops. To re-position the shoulder straps, unbuckle them from the harness buckle and feed these straps through the sewn-in loops, ensuring that they are not twisted. Re-buckle the shoulder straps onto the harness buckle to secure them.

- Bring the seat belt around the child's waist and insert the male ends of the waist/shoulder buckle into the female buckle. Ensure that they snap into place. See Figure 17. Tighten the waist belt to be snug around the child's waist.
- Both the shoulder straps and the waist/crotch straps may be adjusted using the sliding buckles on these straps. See Figures 18 and 19.

## **WARNING**

**Avoid serious injury from falling or sliding out. Always use the seat belt and harness. This seat unit is not suitable for children under 6 months.**

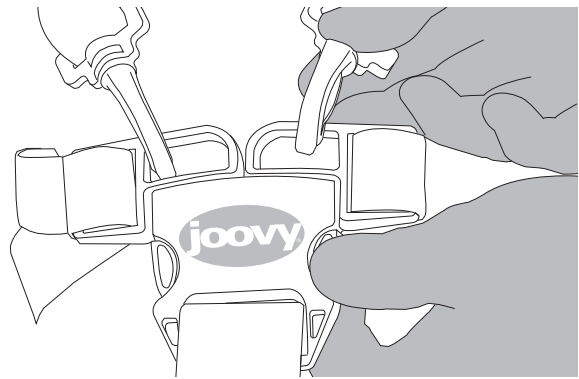

**Figure 16**

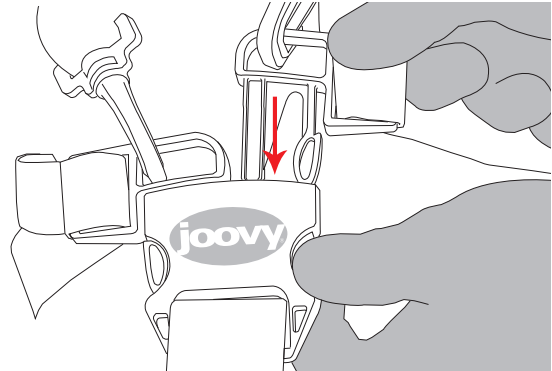

**Figure 17**

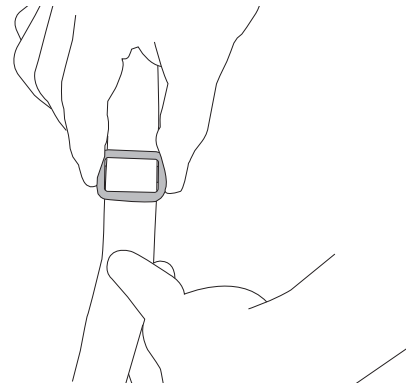

**Figure 18**

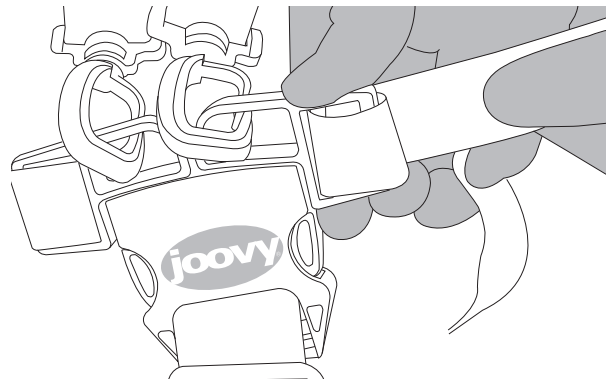

**Figure 19**

## Seatback Positioning

The front seat has two positions. The fully upright position should only be used for a child that is at least 6 months old.

- To place the seat in the upright position, push the bar on the rear of the seat toward the front of the stroller and rotate the seatback towards the front of the stroller until this bar is locked in its LOWEST position. See Figure 20.
- To recline the seat, pull the bar on the rear of the seat toward the rear of the stroller and rotate the seatback down until this bar is again in its LOWEST position.

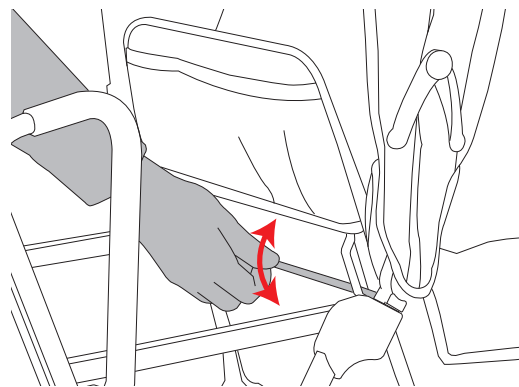

Figure 20

## **WARNING**

**Whether the seatback is upright or reclined, ALWAYS make certain that the rotating bar behind the seatback is in its LOWEST position before placing the child into the seat.**

## Using the Stand-On Platform

- Push the bench seat to its most forward position.
- Position the canopy to its most forward position.
- Position the child on the platform on the back of the stroller. Be sure that the child is facing forward and BOTH of their hands are holding the handles on the frame.
- Be sure that BOTH of the child's feet are fully on the platform at all times.
- You may need to adjust the position of the seatback to allow for more room for the child to stand.

## **WARNING**

**The rear stand-on platform and the rear bench seat are designed for a child that is at least 2-1/2 years old but LESS than 44 inches tall and less than 45 lbs.**

**Use of the stroller with two children weighing more than 45 pounds each, or children totaling more than 90 pounds, will cause excessive wear and stress on the stroller and may cause a hazardous unstable condition.**

**NEVER allow a standing child to use the canopy as a hand hold.**

**NEVER use this stroller to carry more than 2 children at the same time.**

## Using the Rear Bench Seat

- Push the bench seat to its most rearward position.

NOTE: There are webbing straps attached to the bottom of the rear seat pad. These straps will lock the seat into the most rearward position. To lock the seat, pull the straps from EACH side of the pad and loop them around the frame as shown, then snap them together. See Figure 21.

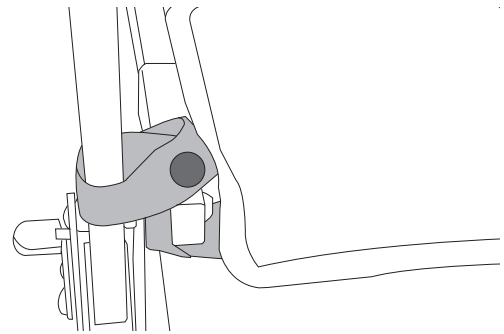

Figure 21

- To slide the seat forward, undo EACH snap and reattach the webbing to the underside of the seat pad using the Velcro® attachments.
- Position the canopy to its most forward position.
- Unlatch the waist buckle by squeezing the latch releases on both sides of the buckle and removing the male ends of each buckle.
- Have the child sit on the bench seat facing backward with their feet on the platform.
- You may need to adjust the position of the seatback to allow for more room for the child to sit.
- Place the crotch strap between the child's legs.
- Bring the seat belt around the child's waist and insert the male ends of the waist buckle into the female buckle. Ensure that they snap into place. See Figure 22.
- Adjust the seat belt to be snug around the child's waist.
- Be sure that BOTH of the child's feet are fully on the platform at all times.
- Be sure that BOTH of the child's hands are holding the handles on the frame.

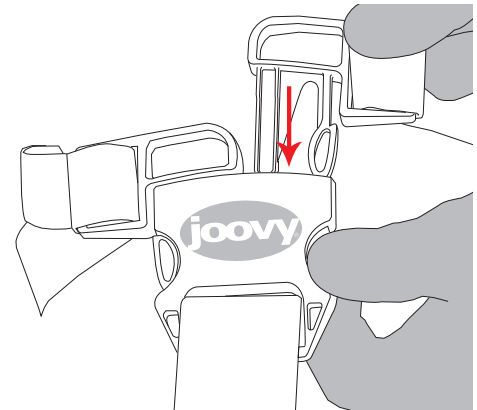

Figure 22

## **WARNING**

**Always use the crotch strap in combination with the waist strap. The rear bench seat is designed for a child that is at least 2-1/2 years old but LESS than 44 inches and less than 45 lbs.**

## Storage Basket

Please note there is a webbing strap with a snap on each side of the basket sides for easy access, or, you can access the storage basket by sliding the rear bench seat forward or backward. The maximum weight that can be carried in the storage basket is 5 pounds. Excessive weight may result in a hazardous unstable condition.

## Using the Stroller as an Infant Car Seat Carrier

- To use the stroller to carry an infant car seat carrier, you must replace the Front Tray with the Car Seat Carrier Support.
- Remove the Front Tray by pressing in on the lock tabs and pulling the tray off the brackets. Store the tray in a convenient place for later use.
- Line up the female fittings on the Car Seat Carrier Support to the male fittings on the front of the stroller and push inward until the fittings snap into place. See Figure 23. Pull outward on both sides of the support to be sure both are snapped securely in place.
- Push the canopy to its most rearward position.
- **ADJUST THE SEATBACK TO ITS 2nd POSITION.**
- Remove the infant carrier from the car seat base.
- Place the infant carrier onto the top of the stroller in a **REAR FACING POSITION**, locating the head end of the carrier so that it rests on the Car Seat Carrier Support and the feet end of the carrier so that it rests on the seatback, but **NOT** on the top edge of the seatback. See Figure 24.
- Ensure that the head end of the infant carrier is pushed down firmly inside the frame of the Car Seat Carrier Support and that it is centered side to side.
- Remove the carrier restraining straps from the pouches on both sides of the stroller. Buckle them in place over the **LOWEST** part of the carrier sides. Adjust the straps so they are tight around the carrier but **AWAY** from the child's neck. Pull up on the carrier to be sure it is held on securely. See Figure 25.
- Always check frequently to be sure that the restraining straps are tight across the infant carrier but away from the child's neck.
- When you remove the infant carrier from the stroller, unlock the restraining strap by pressing the button and both side releases. See Figure 26.
- Always replace the two restraining straps back into their side pouches.

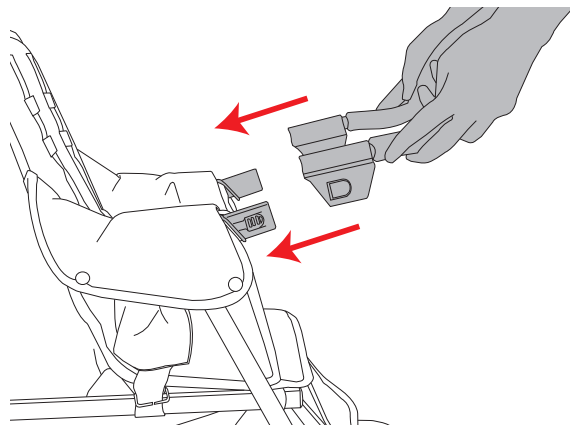

**Figure 23**

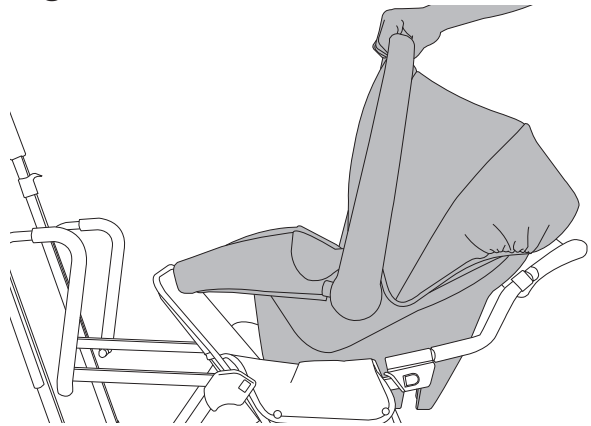

**Figure 24**

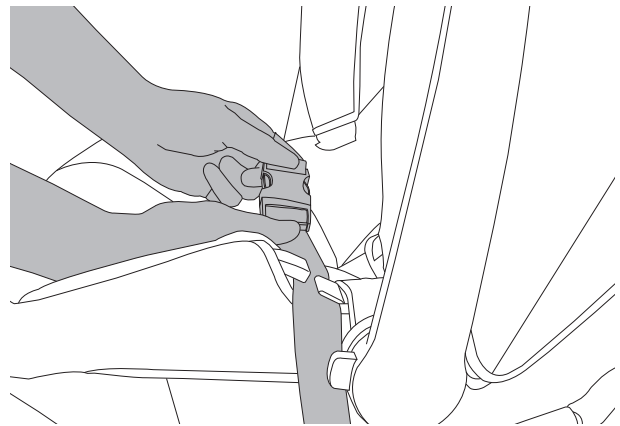

**Figure 25**

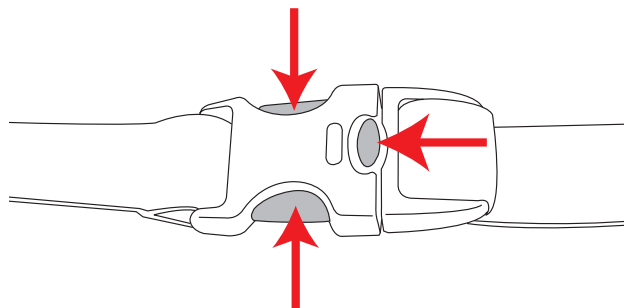

**Figure 26**

## **IMPORTANT NOTE**

When using your stroller as an infant car seat carrier, the following are the compatible infant car seat models that the Caboose will accommodate:

- Baby Trend® Latch-Loc and Flex-Loc
- Britax® B-safe
- Britax® Chaperone
- Britax® Companion™
- Chicco® Key Fit
- Chicco® Key Fit 30
- Combi® Centre Series
- Combi® Connection
- Combi® Shuttle
- Compass Lamaze
- Cybex Aton
- Eddie Bauer® Infant Car Seat (models 22-625 and 22-626)
- Evenflo® Embrace™
- Graco® Safe Seat™
- Graco® Snug Rider™ Series
- Graco® Snug Rider™ 32
- Graco® Snug Rider™ 35
- Maxi Cosi Mico
- Peg Perego® Primo Viaggio
- Peg Perego® Primo Viaggio SIP
- Peg Perego® Primo Viaggio SIP 30/30
- Safety 1st® Designer 22™
- Safety 1st® onBoard 35 Air
- Safety 1st® onBoard 35

For the most updated list of compatible infant car seats, please either check our website at [www.joovy.com](http://www.joovy.com) or call our Customer Service Department at (877) 456-5049.

## **WARNING**

**ALWAYS** install the infant carrier so that the child is facing toward the rear (handle) of the stroller with the restraining straps secured.

**ALWAYS** position the infant carrier so that it is securely placed down inside the Car Seat Carrier Support frame.

**ALWAYS** position the infant carrier so that it is resting **ON** the seatback, but **NOT** on the top of the seatback. The seatback must be in the 2nd position.

**NEVER** position the carrier restraining straps on or near the child's neck as this may result in strangulation.



Right Way



## Folding the Stroller

- Keep children away from stroller while folding.
- Remove any infant carrier that has been installed on the stroller. Note that the stroller can still be folded with the car seat carrier support in place.
- Position the stroller with the handle bar closest to you.
- Place the canopy into its closed position and push it all the way forward toward the front of the stroller as far as it will go.
- If necessary, rotate the front seat to the most upright position.
- Make sure both rear wheel brakes are set to their locked positions.
- Lock both front wheels in place with the locking levers facing forward.
- To fold, unlatch the safety latch on the lower left side of the stroller. See Figure 27.
- Pull upward on the trigger mechanisms on both sides of the stroller. See Figure 27.

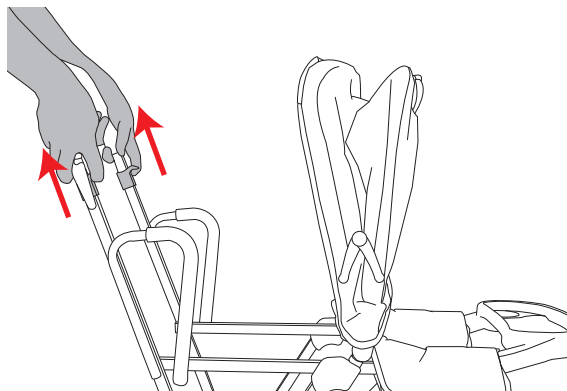

**Figure 27**

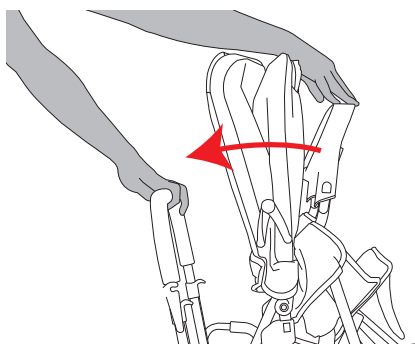
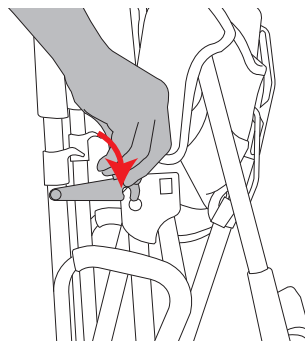

**Figure 28**

- While these mechanisms are in the upward position, push forward on the stroller using the handle bar.
- Once the stroller begins to fold, push the handle all the way forward and down until the stroller is completely folded. See Figure 28.

**CAUTION:** While folding the stroller, be careful to keep your fingers from being pinched by moving parts.

- Secure the stroller in the folded position by engaging the locking latch on the right side of the stroller over the extended rivet. See Figure 29.



**Figure 29**



## Maintenance

All of the fittings, snaps, locks, rivets, and other hardware and plastic parts on the stroller should be inspected periodically to ensure that they are secured properly and not damaged or malfunctioning. The seat belts and safety harnesses, as well as all other straps and fabric items and their stitching should also be inspected periodically to ensure that they are secured properly and not loose, torn or otherwise damaged. All moving parts, such as wheels, brakes, and hinges should also be checked periodically to ensure they are operating properly.

Any missing, broken, or worn components should be replaced immediately, and the stroller should not be used until they are replaced. Only original manufacturer's components should be used. If needed, please contact Joovy at our toll-free phone number.

Fabric fading may occur if the stroller is left in direct sunlight for long periods of time. When not in use, store the stroller out of direct sun.

## Cleaning

The fabric material on this stroller can be cleaned using mild household soap or detergent and warm water on a sponge or clean cloth. Always allow the fabric to completely air dry before using the stroller.

The frame and wheels should always be kept clean and free of dirt and foreign matter, especially after operating the stroller in rain, snow, or other harsh environments. Use a sponge or cloth dampened with warm water and a mild household soap or detergent to clean the wheels after such use.



## SATISFACTION GUARANTEED

We want you to be completely satisfied with your purchase of this product. Should you experience any difficulty in assembling or using this product, or if you have any questions, please contact our Customer Service Department at (877) 456-5049 between the hours of 8:30 am and 5:00 pm Central Time.



# Parent Organizer

**For Use with the Joovy Caboose™**

Deluxe neoprene parent organizer

2 Cup holders

Zippered pocket

Three additional pockets

No tools needed for installation

# Dry *and* Snug

## Rain Cover for The Caboose™

**Protects Against Rain, Wind & Bugs**

Custom rain cover for both children

Zippered button hole pass through for front seat



Please log onto [www.joovy.com](http://www.joovy.com) to register your new Joovy product.

0 Items in Shopping Cart

Login

Account

Go

[home](#) [products](#) [blog](#) [customer service](#) [contact](#)



The Joovy Room is the most comfortable playspace available for your child

### Introducing the Room

Ultra lightweight, roomy and super soft



MORE

### Customer Service

Joovy is BIG ideas from a small company we answer our phones, why not call us?  
877-456-5049 or [email us](#)

### We are Joovy...

An American company with facilities in Dallas, Texas and Orange County, California.

We offer parents amazing solutions for families on the go! Our line incorporates the highest quality features, fun designs and affordable pricing.

Our customers come first! As busy parents ourselves, we understand the importance of time and appreciate that you, too, are busy. We love to answer the phone when you call and we encourage you to contact us directly with any questions or concerns.

### Sign Up For Specials!

first name

last name

email address

submit



### Featured: CocoonX2 Stroller



The CocoonX2 is a stroller-jogger-bicycle trailer all in one! The first time...

[learn more](#)

Look for these other Joovy products



# Room<sup>2</sup>

# Groove™



# ergo Caboose™

# Caboose™ Ultralight





**Zoom**<sup>TM</sup>  
*AFS*

**Kooper**<sup>TM</sup>



**Nook**<sup>TM</sup>



Joovy • 2919 Canton Street • Dallas, TX 75226 • (877) 456-5049 • Fax: (214) 761-1774  
Email: [customerservice@joovy.com](mailto:customerservice@joovy.com) • Web Site: [www.joovy.com](http://www.joovy.com)

©Joovy 2011 • Document Version 092011